

BNI

FEATURES ;

- Accuracy for center inner diameter guaranteed to 0,003,
- Accuracy after point locking guaranteed to 0,005,
- Excellent for individual production of various workpieces through different insert shafts,
- Heat-treated point to HRC 60±2,
- 6 types of standard point is available,
- Because of the insert shafts, the admissible workpiece weight is limited,
- Mounting taper of point is 1/10 degree,
- Order made speical shae point is available.

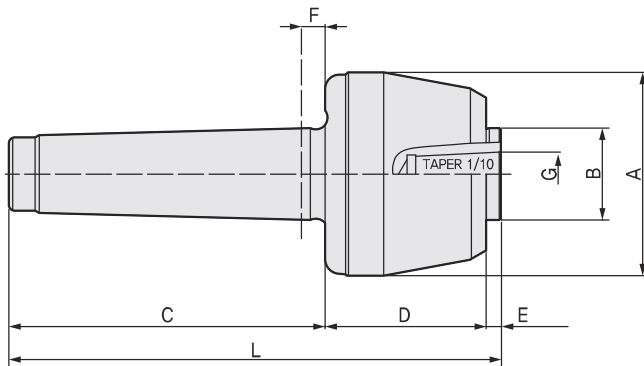

Dimension

Unit : mm, kg

MODEL	MT	A	B	C	D	E	F	G	L	Workpiece Weight	Max, R.P.M	Weight	Max, Run Out
051002	2	50	25	68	43,5	5	6	12	116,5	80	5,000	0,6	0,005
051003	3	50	25	85	43,5	5	6	12	133,5	150	5,000	0,8	0,005
051004	4	69	32	108	55	5	8	15	168	250	3,800	1,7	0,005
051005	5	88	40	136	70	6	8	22	212	650	3,000	3,9	0,005

※ Order example : '051004 Body' = MT4 BNI body only(without an insert shaft)
 '051004 SET' = MT4 BNI body and 6 insert shaft included

BNI type technical data

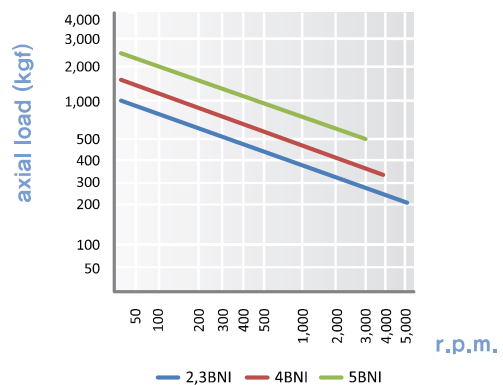
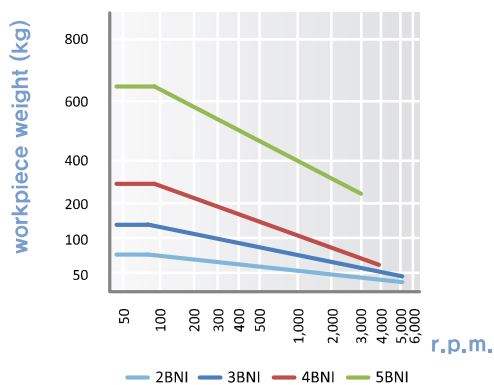

BNI POINTS

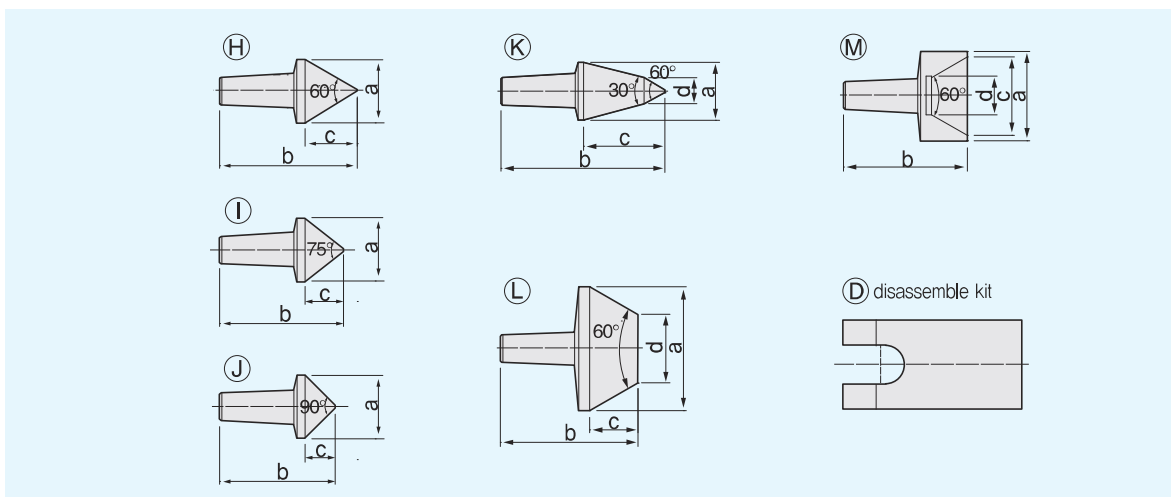

※ Set of BNI includes 6 type of insert shaft and disassemble kit

Dimension

Unit : mm, kg

MODEL	MT		H	I	J	K	L	M
051002	2	a	24	24	24	18	45	22
		b	51,5	46,5	43	54	51	60
		c	20	15	11,5	25	17,5	18
		d				8	25	6,5
051003	3	a	24	24	24	18	45	22
		b	51,5	46,5	43	54	51	60
		c	20	15	11,5	25	17,5	18
		d				8	25	6,5
051004	4	a	28	28	28	26	55	40
		b	61,5	55,5	51,5	73	61,5	55
		c	23,5	17,5	13,5	36	21,5	35
		d				12	30,2	16,5
051005	5	a	38	38	38	32	70	52
		b	78	70	64	90	74	65
		c	32	24	18,5	46	20	45
		d				13	40	25,4

※ Order example: '051004H' = MT4 BNI insert shaft type: H

BN

BNN

BNH

BS

BHS

TN

WP

BP80

BP60

BNI

DC

SD

FD

HS

BB