

TN

FEATURES ;

- Accuracy guaranteed to 0,003mm TIR (0,0001").
- Excellent for CNC and conventional machines.
- Heavy duty type.
- Heat-treated point to HRc 60±2.
- Based on taper roller bearing assembly for superior performance.
- Carbide point available (TNC TYPE).
- Carbide point to HRa 90±5.

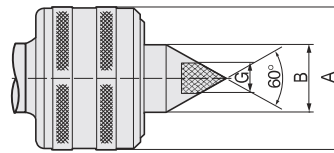
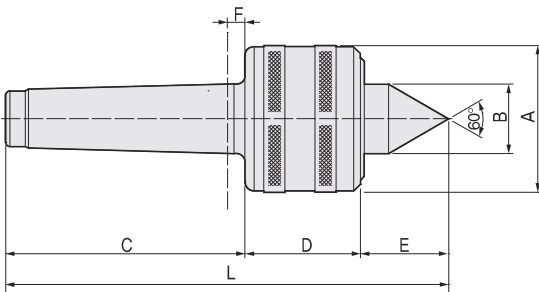

Available

Carbide Tipped Points **TNC-TYPE**

- MT3 : 062003
- MT4 : 062004
- MT5 : 062005
- MT6 : 062006

Dimension

Unit : mm, kg

MODEL	MT	A	B	C	D	E	F	G	L	Workpiece Weight	Max, R.P.M	Weight	Max, Run Out
061003 (062003)	3	51	25	85	44	28	6	10	157	400	4,000	0.8	0.003
061004 (062004)	4	66	32	108	52	40	8	14	200	650	3,000	1.8	0.003
061005 (062005)	5	93	40	136	70	43.7	8	18	249.7	2,500	2,000	4.3	0.003
061006 (062006)	6	127	58.5	189	92.7	61.5	10	30	343.3	4,500	1,000	12.5	0.005
061006H	6	168	80	191	120	84	10	-	395	8,000	800	20	0.005
061007	7	177	78.5	260	110	80	12	-	450	5,000	500	32	0.010
061008	7	177	78.5	260	124	80	12	-	464	10,000	500	34	0.010

※ (MODEL NO) : Carbide Tip Type

TN type technical data

